

- Este manual deve ser guardado para futura consulta, caso necessário.
- This manual should be retained for future reference, if necessary
- Este manual debe guardarse para futuras referencias, si es necesario.



Nº	CÓDIGO	DESCRIÇÃO / DIMENSÃO (mm)	MATERIAL / ACABAMENTO	QUANTIDADE
	CODE	DESCRIPTION / DIMENSION (mm)	Raw Material / FINISH	QUANTITY
	CÓDIGO	DESCRIPCIÓN / DIMENSIÓN (mm)	MATERIA PRIMA / TERMINACIÓN	CANTIDAD

### CORPO / CARCASS / CAJA

01-	3000001339	LATERAL DIR IG3G4GD-105TL BRA / 690 X 400 X 15 MM	AÇO/STEEL/ACERO - BRANCO/WHITE/BLANCO	1
02-	3000001061	LATERAL ESQ IG3GI-105 BRA / 690 X 400 X 15 MM	AÇO/STEEL/ACERO - BRANCO/WHITE/BLANCO	1
03-	3000001331	COSTA IG3G4GD-105TL BRA / 1047 X 690 X 15 MM	AÇO/STEEL/ACERO - BRANCO/WHITE/BLANCO	1
04-	3000001053	FUNDO IG3GI-105 BRA / 1048 X 400 X 15 MM	AÇO/STEEL/ACERO - BRANCO/WHITE/BLANCO	1
05-	3000001056	FUNDO IG2-70 BRA / 698 X 400 X 15 MM	AÇO/STEEL/ACERO - BRANCO/WHITE/BLANCO	1
06-	3000001044	CALHA SUPERIOR IG3GI-105 BRA / 1042 X 23 X 20 MM	AÇO/STEEL/ACERO - BRANCO/WHITE/BLANCO	1
07-	3000000562	COLUNA IG3G4-120TL BRA / 660 X 30 X 11 MM	AÇO/STEEL/ACERO - BRANCO/WHITE/BLANCO	1
08-	1000001321	KIT GD PLASTICA TL BR 347X90 ACO / 347 X 90 X 19 MM	PLÁSTICO/PLASTIC/PLÁSTICO - BRANCO/WHITE/BLANCO	4
09-	3000001336	FUNDO GAV IG-35TL ANITA BRA / 417 X 292 X 15 MM	AÇO/STEEL/ACERO - BRANCO/WHITE/BLANCO	4

### PORTAS / DOORS / PUERTAS

10-	3000002846	PORTA SS ALTA-35 CRIATIVA BRA / 685 X 347 X 20 MM	AÇO/STEEL/ACERO - BRANCO/WHITE/BLANCO	1
11-	3000002850	PORTA SS ALTA-35 CRIATIVA BRA / 685 X 347 X 20 MM	AÇO/STEEL/ACERO - BRANCO/WHITE/BLANCO	1

### FRENTE GAVETA / DRAWER FRONT / FRENTE DE CAJÓN

12-	3000002539	FRENTE GAV-35 IG3G4 GDTL ANITA BRA / 347 X 167 X 20 MM	AÇO/STEEL/ACERO - BRANCO/WHITE/BLANCO	4
	3000002543	FRENTE GAV-35 IG3G4 GDTL ANITA PTO / 347 X 167 X 20 MM	AÇO/STEEL/ACERO - PRETO/BLACK/NEGRO	4

### TAMPO / COUNTERTOP / CUBIERTA

13-	3100003090	TAMPO IG3-105 DAKAR/ANITA PP-389 / 1051 x 435 x 25 MM	MADEIRA/WOOD/MADEIRA - GRANITO PRETO/BLACK GRANITE/GRANITO NEGRO	1
14-	3100001942	REGUA/ROD 105 MAD PP-389 / 1051 / 70 X 15 MM	MADEIRA/WOOD/MADEIRA - GRANITO PRETO/BLACK GRANITE/GRANITO NEGRO	1

POSIÇÃO DO PUXADOR  
POSICIÓN DEL TIRADOR  
HANDLE POSITION

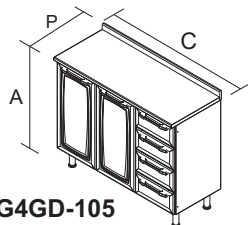

IG3G4GD-105

Produto Montado

C: 1,05 A: 0,90 P: 0,42 M

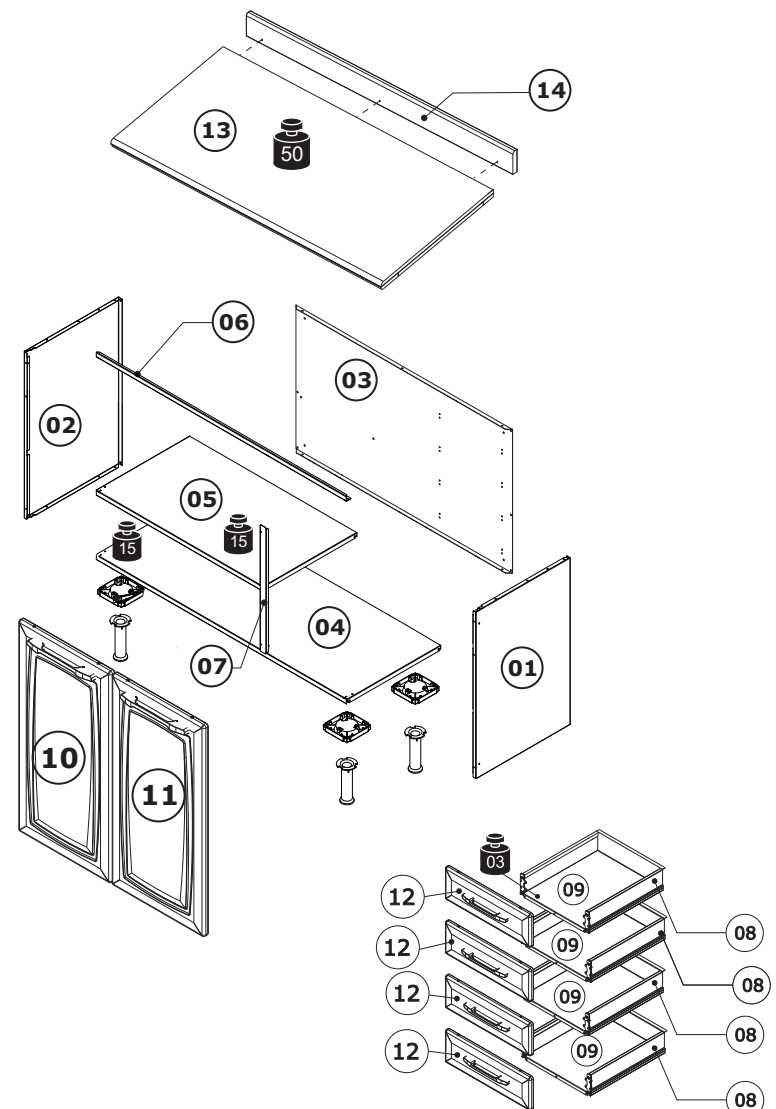
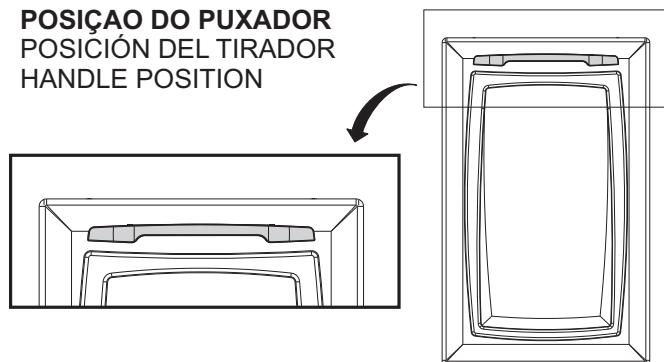

Peso máximo suportado  
Maximum weight supported  
Peso máximo soportado

**FERRAGEM PUXADORES**  
HANDLE HARDWARE  
HERRAJE TIRADORES

**A11** - 1000000211 - 3,5x25 CP

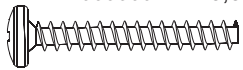

**12**

**F27** - 3000004155 - 19 MM



**12**  
**BUCHA PUXADOR**  
HANDLE SCREW ANCHOR  
TARUGO TIRADOR

**F47** - 3000004163 - 6mm



**20**  
**BATOQUE PORTA - PVC**  
PVC STOPPER  
TOPE PARA PUERTA - PVC

**F76** - 1000000167 - 243 MM

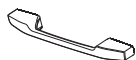

**06**  
**PUXADOR**  
HANDLE  
TIRADOR

PORTA 10 e 11 / Door 10,11/ Puerta 10,11

**PUXADOR / MONTAGEM / DIMENSÃO**  
HANDLE / ASSEMBLING / DIMENSION  
TIRADOR / ARMADO / DIMENSIÓN

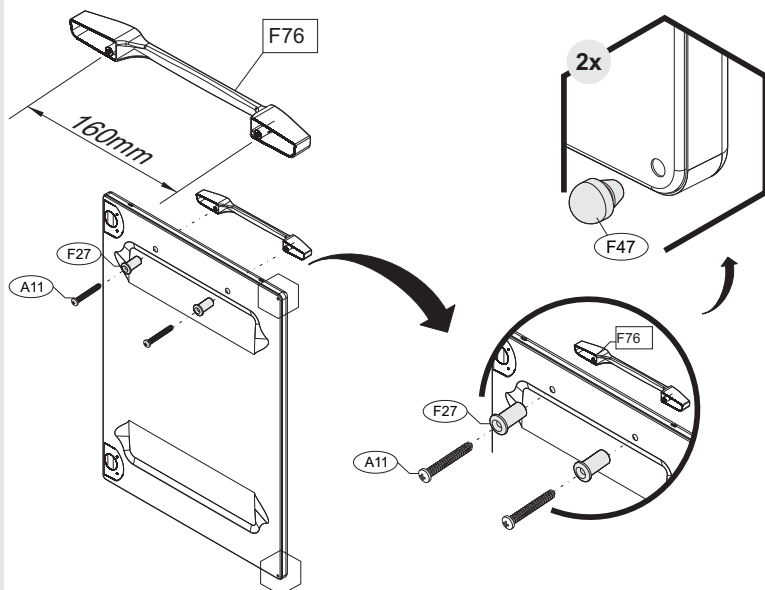

## MONTAGEM DE FRENTE

ASSEMBLING INSTRUCTIONS-CABINETS FRONT PORTION  
ARMADO FRONTAL

FRENTE GAVETA 12/ Draver Front 12/ Frente cajon 12

**PUXADOR / MONTAGEM / DIMENSÃO**  
HANDLE / ASSEMBLING / DIMENSION  
TIRADOR / ARMADO / DIMENSIÓN

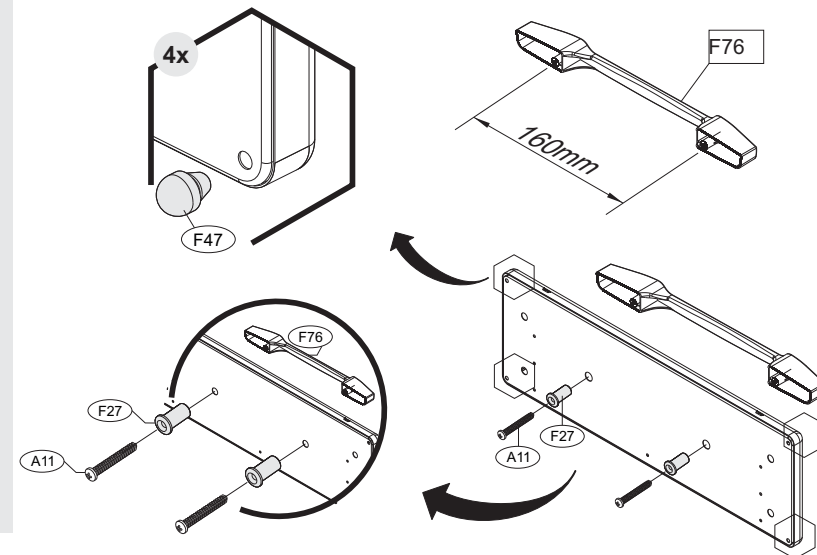

## MONTAGEM DOS PÉS

LEGS ASSEMBLY  
ARMADO DE LAS PATAS

**A13** - 1000000227 - 3,5x14 CC

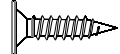

**12**

**F102** - 3000000061



**04**  
**BASE PE PLASTICA**  
LEG BASE  
BASE DE PATA PLASTICA

**F104** - 3000004172



**04**  
**PÉ ARMARIO**  
FOOT CABINET  
PATA

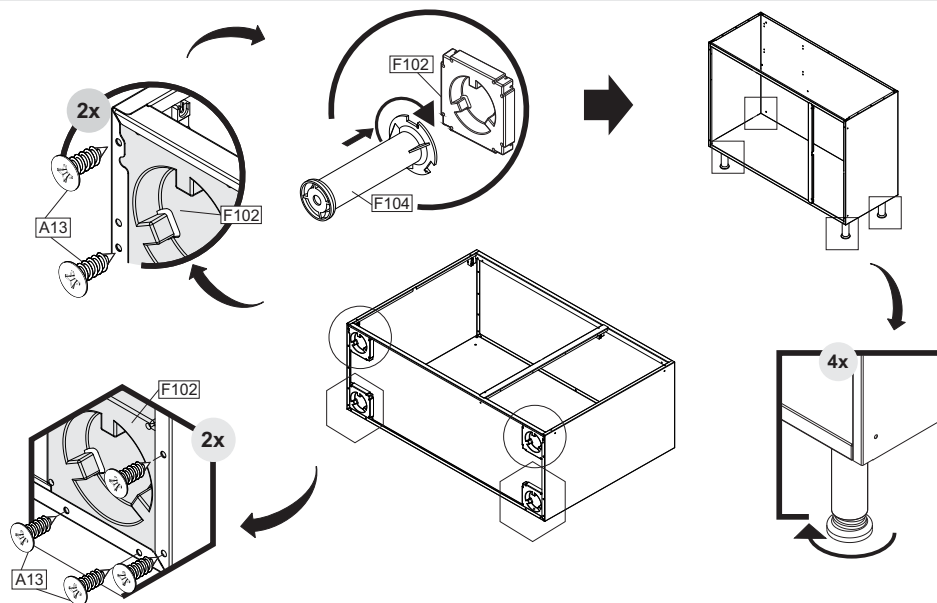

## MONTAGEM DO TAMPO

COUNTERTOP ASSEMBLING  
ARMADO DE LA CUBIERTA

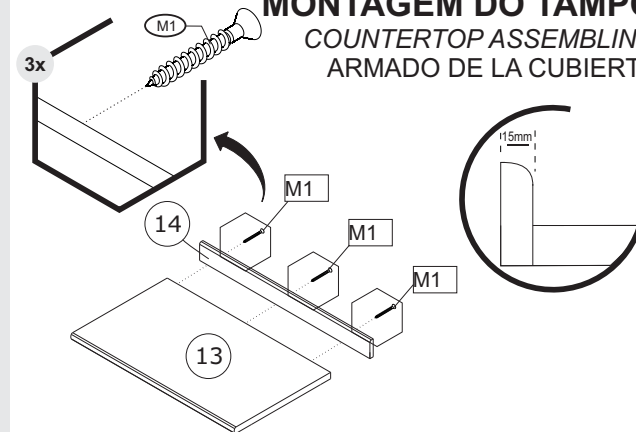

**M1** - 1000001179 - 3,5x40 CC

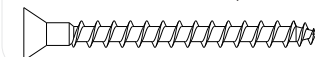

**03**