

Fixação na Parede/Montaje en la Pared
Wall Assembly

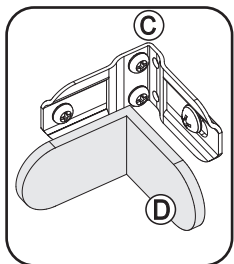

União dos Módulos / Unión de los
módulos / Pieces Junction

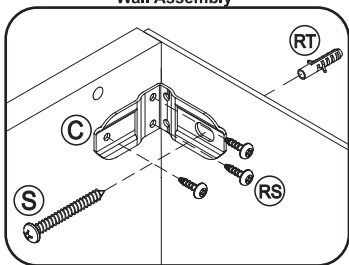
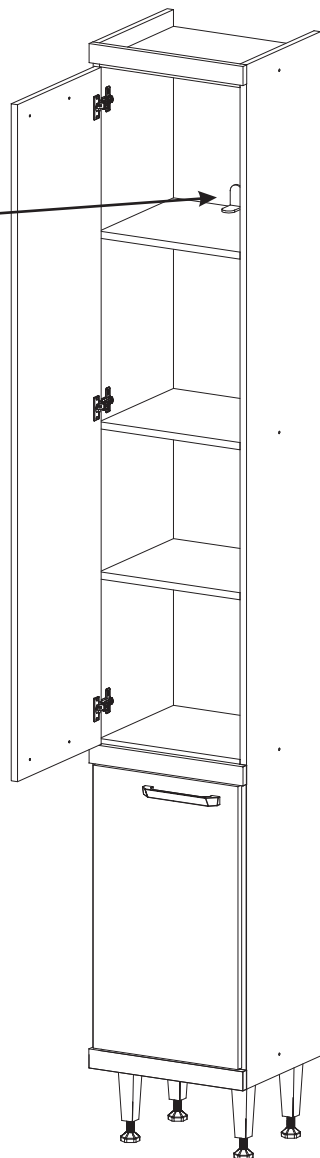
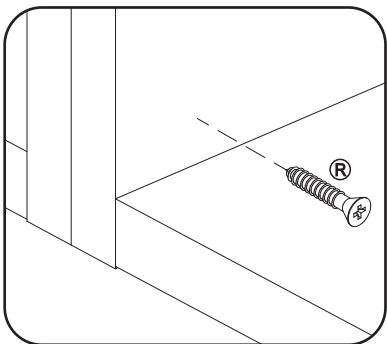

MULTIMÓVEIS









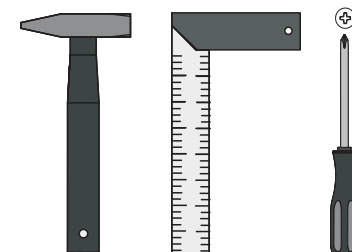
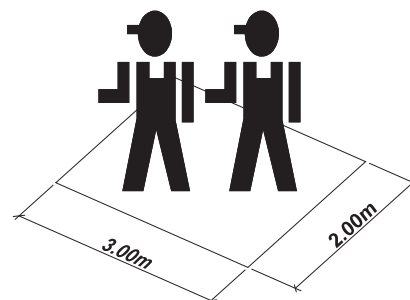
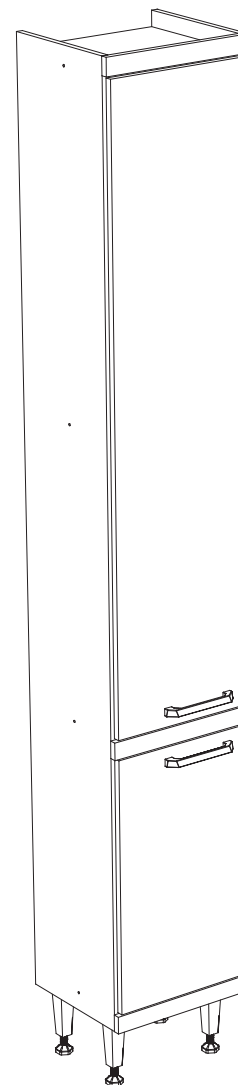



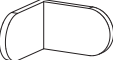

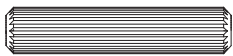

decor

Rua Carlos Dreher Neto, 1918, Fone: (54) 2102 4000, FAX: (54) 2102 4050
CEP 95700-000 - BENTO GONÇALVES - RS - BRASIL
CNPJ: 00.349.443/0001-92
e-mail: multimoveis@multimoveis.com / site: www.multimoveis.com

INSTRUÇÕES DE MONTAGEM INSTRUCCIONES DE ARMADO ASSEMBLY INSTRUCTIONS

REF.: 5116



A		Tampa Adesiva	12
B		Parafuso 4,5 x 50	08
C		Suporte Aéreo	01
D		Capa p/ Suporte Aéreo	01
E		Parafuso 3,5 x 14	20
H		Cavilha 6,0 x 30	28
R		Parafuso 4,0 x 25	04
X		Pé com Regulagem	04
Y		Prego 10 x 10	40
AA		Dobradiça	05
BW		Parafuso 3,5 x 25	04
BX		Bisnaga de Cola 5g	01
XX		Puxador 160mm	02
S		5,0 x 45	05
RS		3,5 x 14	03
RT		Bucha Ø8mm	01
CC		Parafuso 3,5 x 12	20
AT		Cantoneira	10

Passo
Paso
Step

04

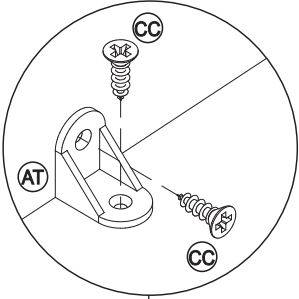
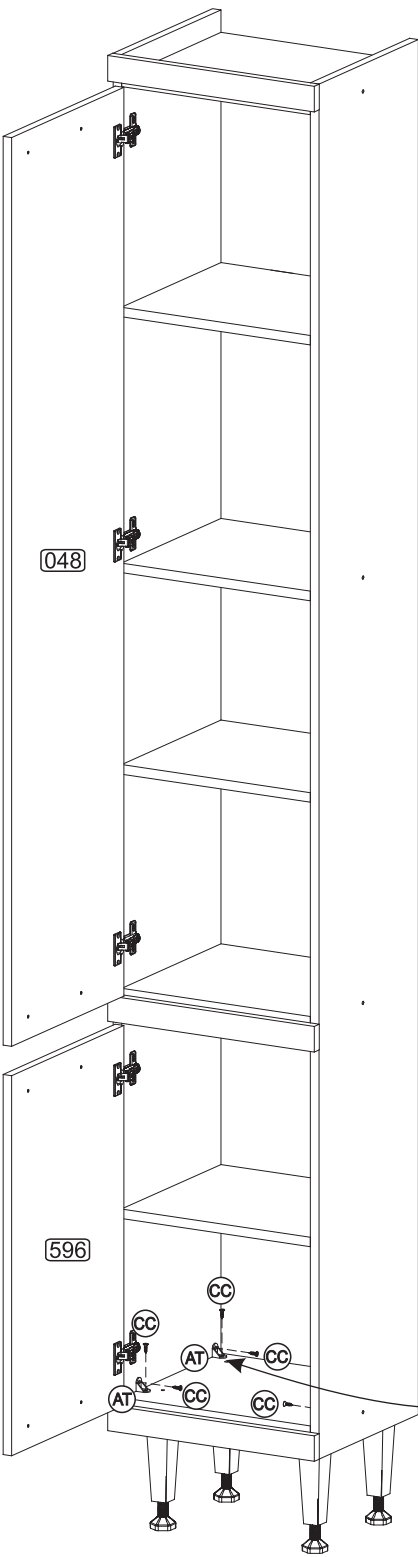
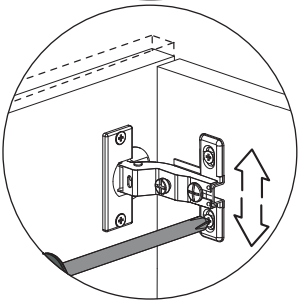
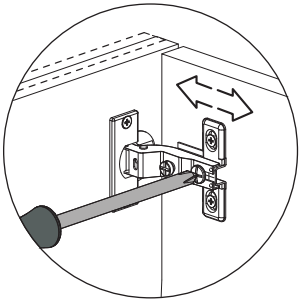
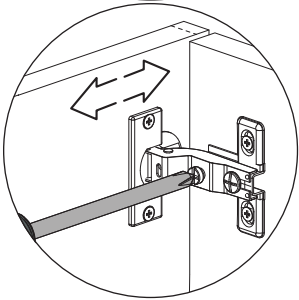
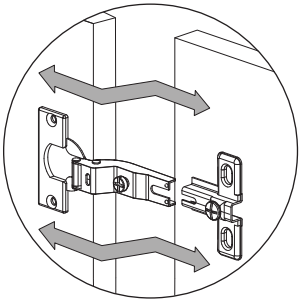

Utilizar a régua abaixo para medir as ferragens:

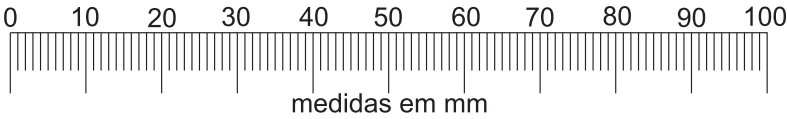

medidas em mm

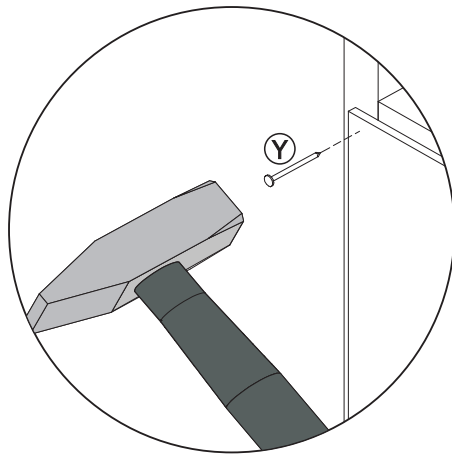
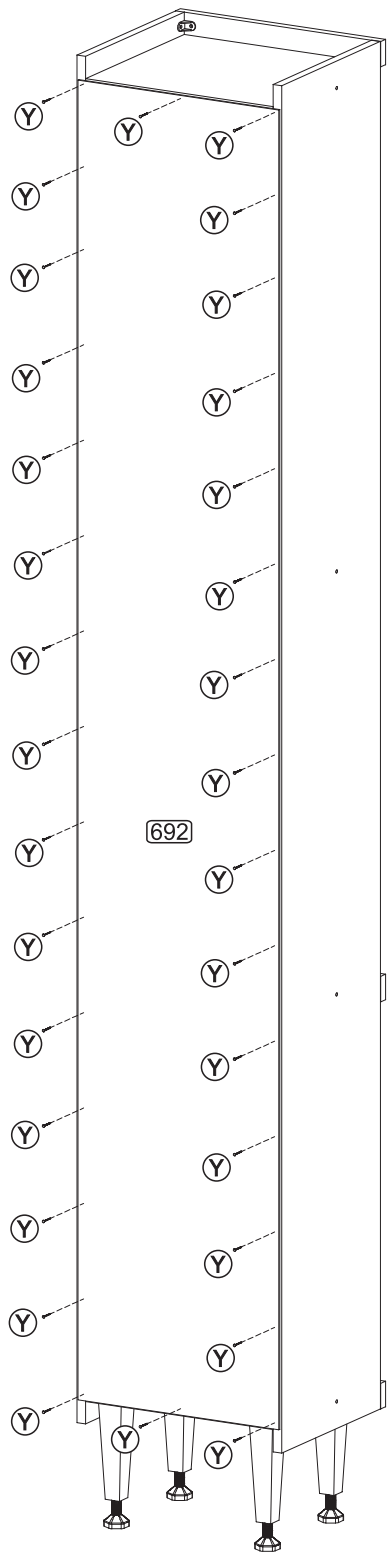

Senhor montador!
Informamos que a numeração das peças encontra-se no topo das mesmas conforme desenho acima.

Señor Armador!
Les informamos que la numeración de las piezas encuentranse arriba de las mismas, de acuerdo al modelo arriba.

Dear Assembler!
We inform you that the number of each piece is located on the top of it, according to the model shown above.

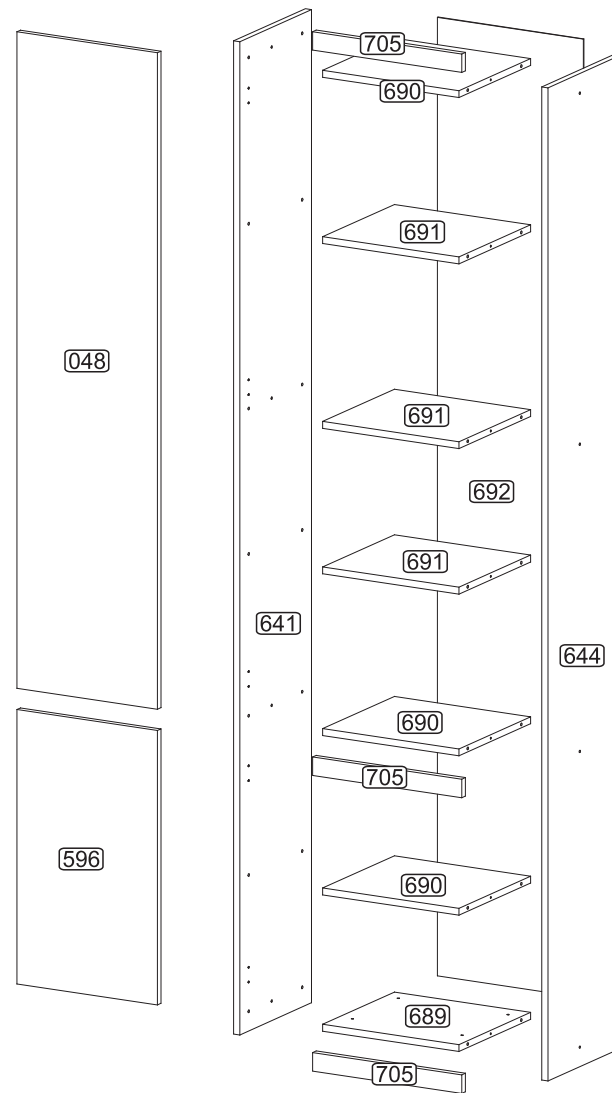

LISTA DE PEÇAS	
Nº	DENOMINAÇÃO
048	- PORTA MAIOR
596	- PORTA MENOR
641	- LATERAL ESQUERDA
644	- LATERAL DIREITA
689	- BASE
690	- TAMPO
691	- PRATELEIRA
692	- COSTA
705	- MOLDURA



LISTA DE PIEZAS	
Nº	DENOMINACIÓN
048	- PUERTA MAYOR
596	- PUERTA MENOR
641	- LATERAL IZQUIERDA
644	- LATERAL DERECHA
689	- BASE
690	- TAPA
691	- ESTANTE
692	- RESPALDO
705	- MOLDURA



PART LIST	
Nº	DESCRIPTION
048	- LARGER DOOR
596	- SMALLER DOOR
641	- LEFT SIDE
644	- RIGHT SIDE
689	- BASE
690	- TOP
691	- SHELF
692	- BACK
705	- FRAME

PRÉ-MONTAGEM / PRÉ-ARMADO / PRÉ-ASSEMBLAGE

Passo
Paso
Step

01

COBRIR OS PARAFUSOS
TAMPA ADESIVA
TAPA ADESIVA
STICKER
TAPA LOS TORNILLOS / COVER THE SCREWS

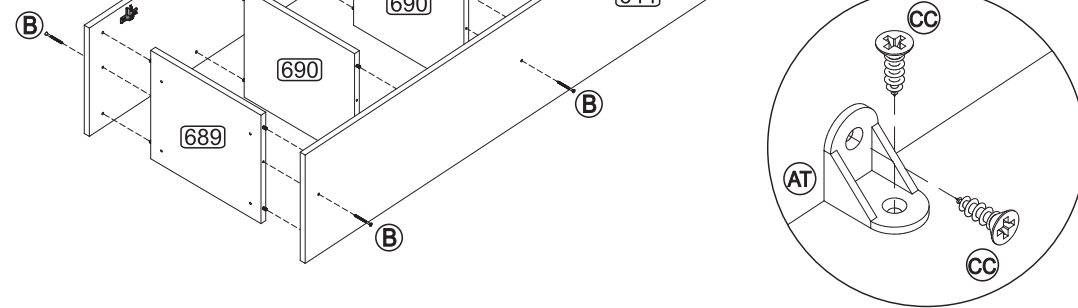

Passo
Paso
Step

02

